

EBS010

Mounted Breathalyser System

The EBS010 is a high-speed automatic industrial breathalyser used to check for alcohol on the breath of workers at turnstiles, entrances to sites, offices, mines, refineries and warehouses.

A Pass result will allow access to the premises and a Fail result will prevent access. Breath tests are ethanol specific and the EBS010 can perform up to 12 tests per minute.

FEATURES

- Ethanol specific electrochemical fuel cell sensor
- Air flow rate checking for no blows with a pressure sensor
- Calibrated to Fail from 0.01% BAC
- Fully interchangeable and replaceable sensor module

SPECIFICATIONS

Indication of B.A.C	Pass is below 0.01% B.A.C. - Fail can be set to fail from 0.01% B.A.C and up
Accuracy	+/- 0.001% B.A.C at 0.050% B.A.C
Mouth Piece	No Mouthpiece required
Sensor Type	Replaceable fuel cell alcohol sensor
Power Supply	12VDC 1.5A
Weight	550g
Dimensions (mm)	205 x 108 x 95 (HxWxD)



*Annual calibration is recommended.

COMPATIBLE BIOMETRIC DEVICES



EBZ500-SERIES



EBZ101 EBSF850

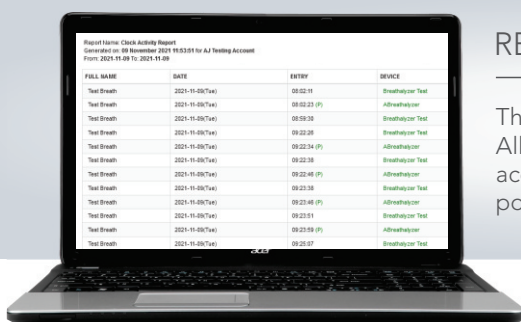
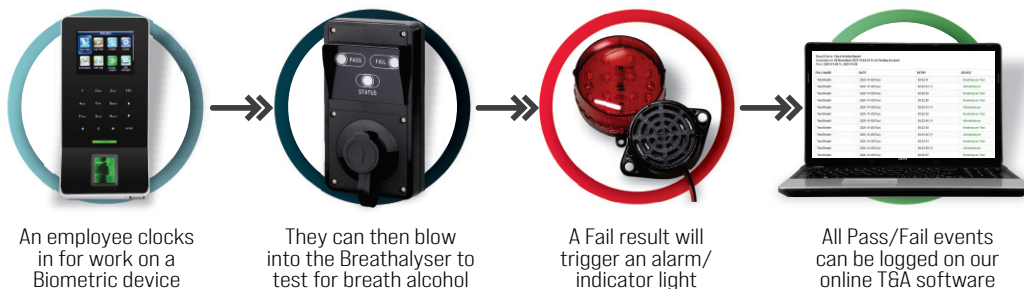

REPORTING (OPTIONAL)

The breathalyser can be set up to communicate with our online reporting system. All breathalyser test blow events will be displayed and can be broken down according to date ranges, specific employees, or departments. This includes both positive (FAIL) and negative (PASS) results.

*Please note that the breathalyser can also be installed as stand-alone, without an access control element.